

FOR AN EVENT



BEYOND
EXPECTATION

Choose to make your next business event exceptional by selecting L'Aqua. Located on the rooftop of Cockle Bay Wharf and within walking distance to the CBD with nearby parking and public transport, L'Aqua ticks all the boxes for you and your delegates. Ideal for seminars, conferences, dinners, lunches, breakfasts and intimate functions, L'Aqua is a leading venue in the business events industry. Our team are highly experienced, approachable and are easy to work with. Enjoy the natural light of the venue or take advantage of our state-of-the-art full black-out capability and professional audio visual services. L'Aqua is versatile and can be transformed into a space that suits you business. Discover how you can make your next event a true success at L'Aqua.

Beyond Expectation

L'Aqua

A DOCKSIDE GROUP VENUE

SERVICES & FACILITIES

- Two beautifully appointed dining rooms, the Terrace & Gold rooms with high ceilings and private balconies
- Pillarless, highly versatile, multi-function space
- Fully renovated in 2009 by renowned designer Michael McCann with each room having a distinctive and stylish aesthetic
- Premium range of restaurant quality menus and beverage selections
- On site commercial kitchen facilities
- On site executive chef, kitchen and venue operations team
- Uninterrupted water views of Darling Harbour from the venue
- Outdoor balconies ideal for pre-function area or catering breakout area
- Floor to ceiling glass doors opening out to terrace
- Rooms offer both natural light and automated black out facilities
- Digital venue lighting control
- Fully air-conditioned
- Secretariat support is available upon request
- State of the art audio-visual equipment and service by Impact AV
- ADSL 2 or BSDL Internet access and video conferencing facilities

AUDIO VISUAL FACILITIES / Managed by Impact AV

Terrace Room:

- 3 x Motorised Projection Screens (10ft x 7.5ft)
- Panasonic 5000 Ansi Lumen Event Data Projectors and 1 x 3500 Ansi Lumen Event Data Projector
- Full Venue Professional PA system Martin W0.5 Speakers and Australian Monitor Amplifier
- Prolite 650w Fresnel Stage Lights and dimmer

Gold Room:

- 1 x Motorised Projection Screen (14ft x 10ft)
- Panasonic 6000 Ansi Lumen Event Data Projector
- Full Venue Professional PA System with Martin W0.5 Speakers and Australian Monitor Amplifier
- Prolite 650w Stage Lights and dimmer
- Martin MX-10 Moving Lights Package

Both rooms:

- Portable staging, whiteboards, plasma screens, lecterns, flip charts
- Professional onsite audio-visual technicians to support the seamless running of events

Charges are applicable for all AV equipment and services. Please contact Impact AV on 1300 633 328 or visit impactav.com.au for a quotation.

LOCATION & LANDMARKS

- The venue is located on roof top level (two level above ground level) of Cockle Bay Wharf
- 5-minute walk from Sydney Convention & Exhibition Centre and IMAX Theatre complex
- 5-minute walk from three 4.5 star hotels and Harbourside Shopping Centre
- 10-minute walk from Sydney CBD and Queen Victoria Building
- 2-minute walk from Darling Park Offices (via undercover walk way connecting to Cockle Bay Wharf)
- Adjacent to Pyrmont Bridge (city end)
- 2-minute walk from the Cockle Bay Wharf Marina for water taxi
- 5-minute walk to three parking stations
- Taxi drop off points on Wheat Road and 201 Sussex Street

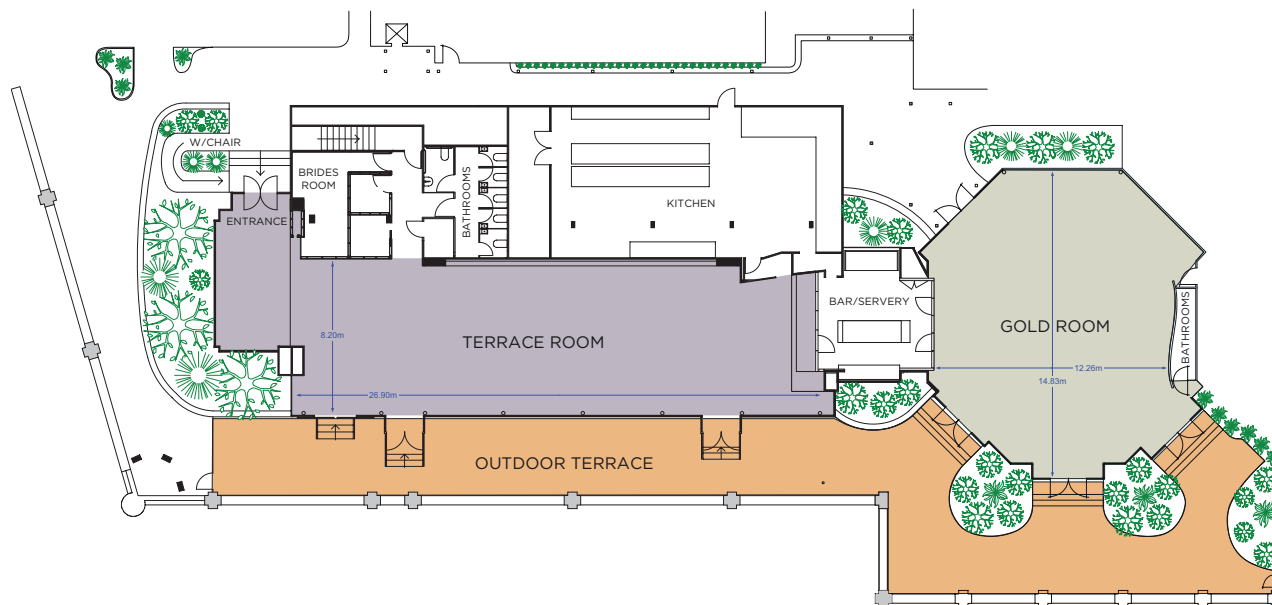

L'AQUA	Measurement (Sqm)	Ceiling Height (m)	Cocktail	Banquet	Banquet w/ Dance Floor	Theatre	Cabaret	Classroom
Entire venue	446	-	550	170	150	-	-	-
Terrace Room	244	2.9 - 3.75	350	170	150	180	120	90
Gold Room	180	4.2	200	130	110	120	80	72

All capacities may vary depending on audio visual, production, entertainment and catering requirements.

Our sales and event management team members will assist you with a floor plan tailored to your event's specifications.

- This venue's banquet table is oval and the measurement is 1.8m X 1.4m. Each banquet table sits 10 persons comfortably.

- Cabaret style up is based on 7 persons per table utilising this venue's banquet table.

- This venue's classroom table measure is 1.8m X 0.45m. Each classroom table sits 3 persons comfortably.

- Theatre style is with chairs only, no tables.